

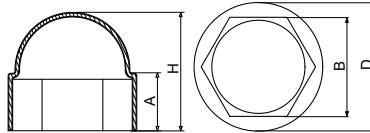

**Schutzkappen**  
Masking caps

## Schutzkappe für Schrauben

Bolt and nut caps



ART.-NR.	TYP	GEWINDE	B [mm]	D [mm]	H [mm]	A [mm]	SCHLUESSEL
600	<b>MS M5</b>	<b>M5</b>	7,9	10,6	9,5	6,0	8
601	<b>MS M6</b>	<b>M6</b>	9,9	13,2	13,4	7,3	10
602	<b>MS M8</b>	<b>M8</b>	12,9	17,6	16,5	8,7	13
603	<b>MS M10</b>	<b>M10</b>	16,9	21,6	20,3	10,1	17
604	<b>MS M12</b>	<b>M12</b>	18,9	23,6	21,9	11,4	19
605	<b>MS M14</b>	<b>M14</b>	21,9	27,4	24,2	12,5	22
606	<b>MS M16</b>	<b>M16</b>	23,9	29,6	27,2	14,0	24
607	<b>MS M18</b>	<b>M18</b>	26,5	33,3	30,3	17,4	27
608	<b>MS M20</b>	<b>M20</b>	29,0	36,5	33,5	18,0	30
609	<b>MS M22</b>	<b>M22</b>	31,3	38,9	36,0	20,0	32
610	<b>MS M24</b>	<b>M24</b>	34,5	43,9	39,3	20,2	36
611	<b>MS M27 H60/A *</b>	<b>M27</b>	41,0	X	60,0	X	41
612	<b>MS M30</b>	<b>M30</b>	45,8	56,0	51,3	24,8	46
613	<b>MS M33</b>	<b>M33</b>	48,7	59,5	56,2	28,3	50
614	<b>MS M36</b>	<b>M36</b>	54,1	66,0	58,0	29,2	55
615	<b>MS M39</b>	<b>M39</b>	59,5	72,0	61,0	34,6	60
616	<b>MS M42</b>	<b>M42</b>	64,0	76,6	63,1	36,6	64
617	<b>MS M45</b>	<b>M45</b>	68,4	84,0	88,4	34,5	70

Bemerkung:

\* Typ: MS M27 H60 \* - From nicht standardmaessig Technische Daten S.24

Material: Polietylen.

Standard Color

RAL 9005 7040 9010



Schutzkappe fuer Schrauben

Bolt and nut elongated cap

Typ: A

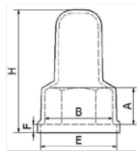

NR ART	TYP
397	MS M12 H44/A
3134	MS M14 H28/A
340	MS M16 H53/A
3203	MS M18 H58/A
2175	MS M22 H70/A *
382	MS M24 H70/A
611	MS M27 H60/A
384	MS M27 H80/A
344	MS M36 H110/A *

Platz fuer Unterlegscheibe.

Typ: B

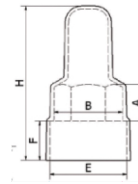

NR ART	TYP
398	MS M12 H54/B 2 x Muttern
342	MS M16 H66/B 2 x Muttern
3204	MS M18 H73/B 2x Muttern
381	MS M20 H88/B 2 x Muttern
343	MS M22 H88/B 2 x nMuttern *
383	MS M24 H90/B 2 x Muttern
385	MS M27 H100/B 2 x Muttern
345	MS M36 H138/B 2 x Muttern *

Platz fuer Unterlegscheibe.

Typ: C

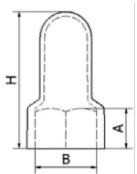

NR ART	TYP
380	MS M20/C H60
3215	MS M20/C H70

Typ: D

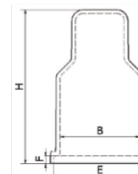

NR ART	TYP
386	MS M30/D H100 2 x Muttern

Platz fuer Unterlegscheibe.

NR ART.	TYP	GEWINDE	B [mm]	H [mm]	A [mm]	E [mm]	F [mm]	SCHLUESSEL
397	MS M12 H44/A	M12	18,9	44,0	11,4	26,0	2,9	19
398	MS M12 H54/B 2 x Muttern	M12	18,9	54,0	11,4	26,0	13,0	19
3134	MS M14 H28/A	M14	21,9	28,0	14,0	34,5	8,4	22
340	MS M16 H53/A	M16	24,2	53,0	16,3	33,0	4,0	24
342	MS M16 H66/B 2 x Muttern	M16	24,2	66,0	16,3	33,0	17,0	24
3203	MS M18 H58/A	M18	26,5	58,0	21,0	33,4	4,0	27
3204	MS M18 H73/B 2 x Muttern	M18	26,5	73,0	21,0	36,5	19,0	27
380	MS M20 H60/C	M20	29,3	65,0	19,0	-	-	30
3215	MS M20/H70/C	M20	29,3	75	29	-	-	30
381	MS M20 H88/B 2 x Muttern	M20	29,3	88,0	19,0	35,5	21,5	30
2175	MS M22/A H70 *	M22	32,3	70,0	21,5	42,0	4,0	32
343	MS M22 H88/B 2 x Muttern *	M22	32,3	88,0	21,5	42,0	22,0	32
382	MS M24 H70/A	M24	35,2	75,0	21,0	46,6	5,0	36
383	MS M24 H90/B 2 x Muttern	M24	35,2	94,0	21,0	46,6	24,0	36
611	MS M27 H60/A	M27	40,0	60,0	24,0	50,0	5,4	41
384	MS M27 H80/A	M27	39,9	83,0	24,0	51,3	5,0	41
385	MS M27 H100/B 2 x Muttern	M27	39,9	99,5	24,0	51,3	27,0	41
386	MS M30 H100/D 2 x Muttern	M30	51,5	99,5	51,0	59,0	5,0	46
344	MS M36 H110/A *	M36	55,5	110,0	33,6	69,0	6,0	55
345	MS M36 H138/B 2 x Muttern*	M36	55,5	138,0	33,6	69,0	33,0	55

Stoff: Polyethylen.

\* Ware in Vorbereitung

Eigenschaften:

► UV-bestaendig

Verwendung:

► wirksamer Schutz vor unguenstigen atmosphaerischen Bedingungen.

► Montage auf akustischen Bildschirmen, Schutzbarrieren, Beleuchtungslampen.

Standardmaessige Farb

